

FLEETWOOD®

Remote Keyless Entry
System

Model: RKE100FW

Battery Replacement and Maintenance

System Maintenance:

The only maintenance that your keyless entry system requires is a periodic check of its operation to be sure that all functions are operating properly. The batteries supplied with your transmitter will usually last about 1 year. Heavier usage will shorten battery life. Reduced transmitter range is usually a sign that the battery in the transmitter is becoming weak and should be replaced.

Note: The battery supplied with the transmitter is not covered under the warranty.

Battery Replacement:

Replacement batteries for your transmitter are available in most drug stores and camera shops. To replace the battery, remove the small Phillips screw from the back of the transmitter case and pull apart the top and bottom case halves. Remove the battery from its holder. Insert the new battery in place of the old one observing the batteries +/- polarity. Gently snap the top and bottom case halves together (Do Not force them together) and replace the Phillips screw (Do Not over tighten the screw).

Caution! The transmitters are not waterproof! Do not submerge them in any liquid. In the event that your transmitter has become wet or soaked, remove the back cover, remove the battery and remove the circuit board from the back cover. Use a blow dryer to dry the moisture. Re-assemble the transmitter and test it. If the transmitter is still inoperative, contact your local dealer for a replacement.

Replacement Transmitter:

In the event that the transmitter supplied with your keyless entry system becomes damaged or lost, return to your local dealership to purchase a new one.

Warranty:

For warranty information contact your Fleetwood Dealer

Enclosed are some brief, but highly important instructions on the operation and maintenance of your new Fleetwood® keyless entry system. It is advisable for you to read this information and become familiar with the operation of your new Fleetwood® keyless entry system. After all, you will be using your new Fleetwood® keyless entry system everyday.

General Operation

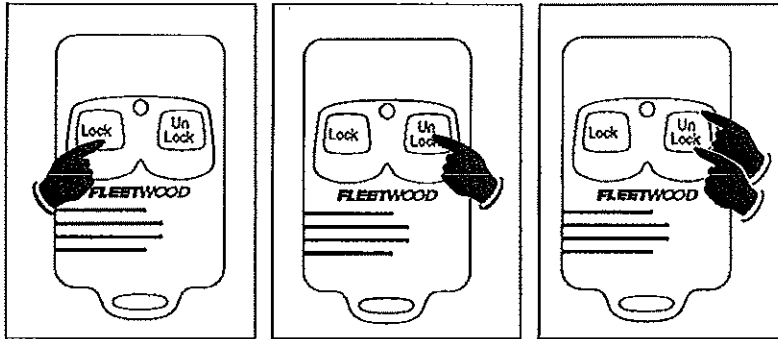

To "Lock" both the driver's and passenger's doors by remote control.

- Depress the "Lock" button on the transmitter (1) time.

To "Unlock" only the driver's doors by remote control.

- Depress the "Un Lock" button on the transmitter (1) time.

To "Unlock" both the driver's and passenger's doors by remote control.

- Depress the "Un Lock" button on the transmitter (2) times.

ENTRY DOOR MUST BE CLOSED

Transmitter Code Learning

This keyless entry system can learn up to 4 different transmitters. To add additional or a replacement transmitter follow the steps below:

PROCEED TO STEP TWO WITHIN 5 SECONDS OF STEP ONE COMPLETION

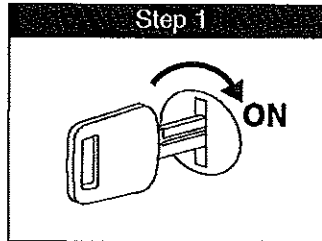

Turn "On" the Ignition switch.

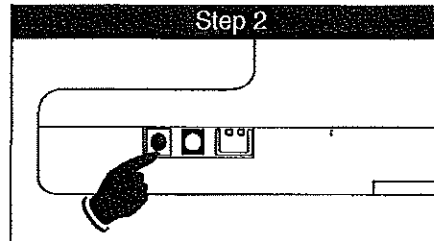

Depress the black button on the control module 3 times. *↳ BUTTON MAY BE BLACK OR RED*

- The LED will come on solid.

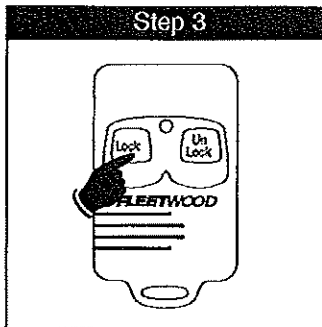

Depress the "Lock" button on each new transmitter(s) to be learned.

- The LED will flash once when it learns the transmitter's code.

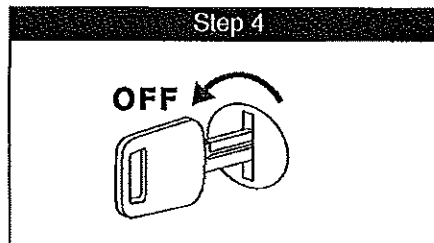

Turn "Off" the Ignition switch.

- The LED will be off.